

# Eduphoria - Instructions for Creating a Test

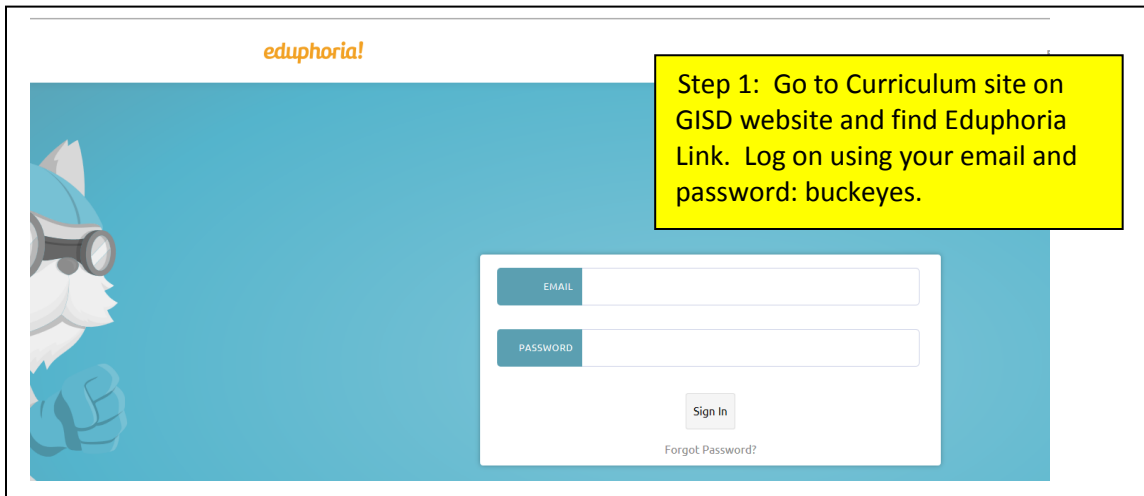

Step 1: Go to Curriculum site on GISD website and find Eduphoria Link. Log on using your email and password: buckeyes.

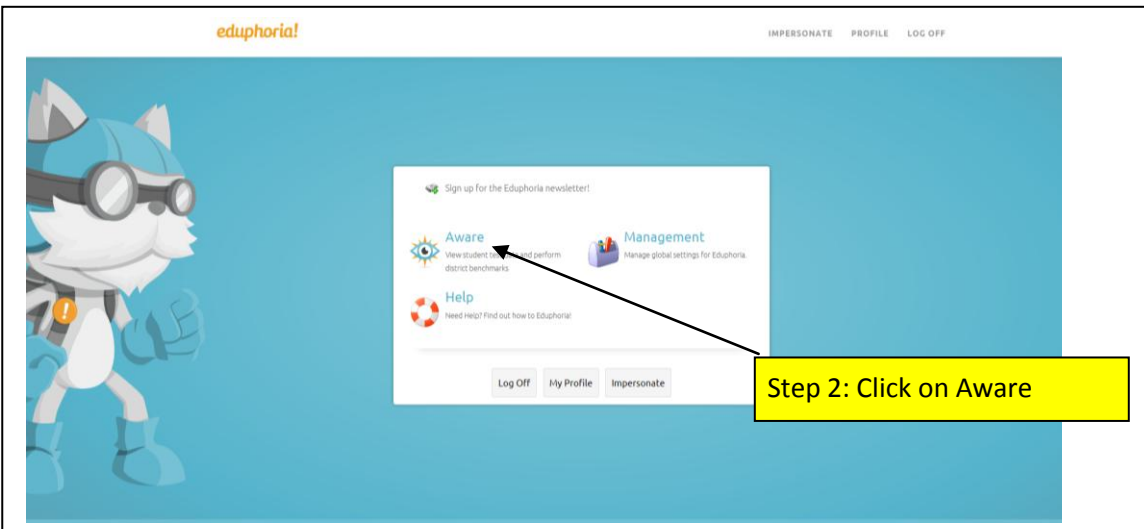

Step 2: Click on Aware

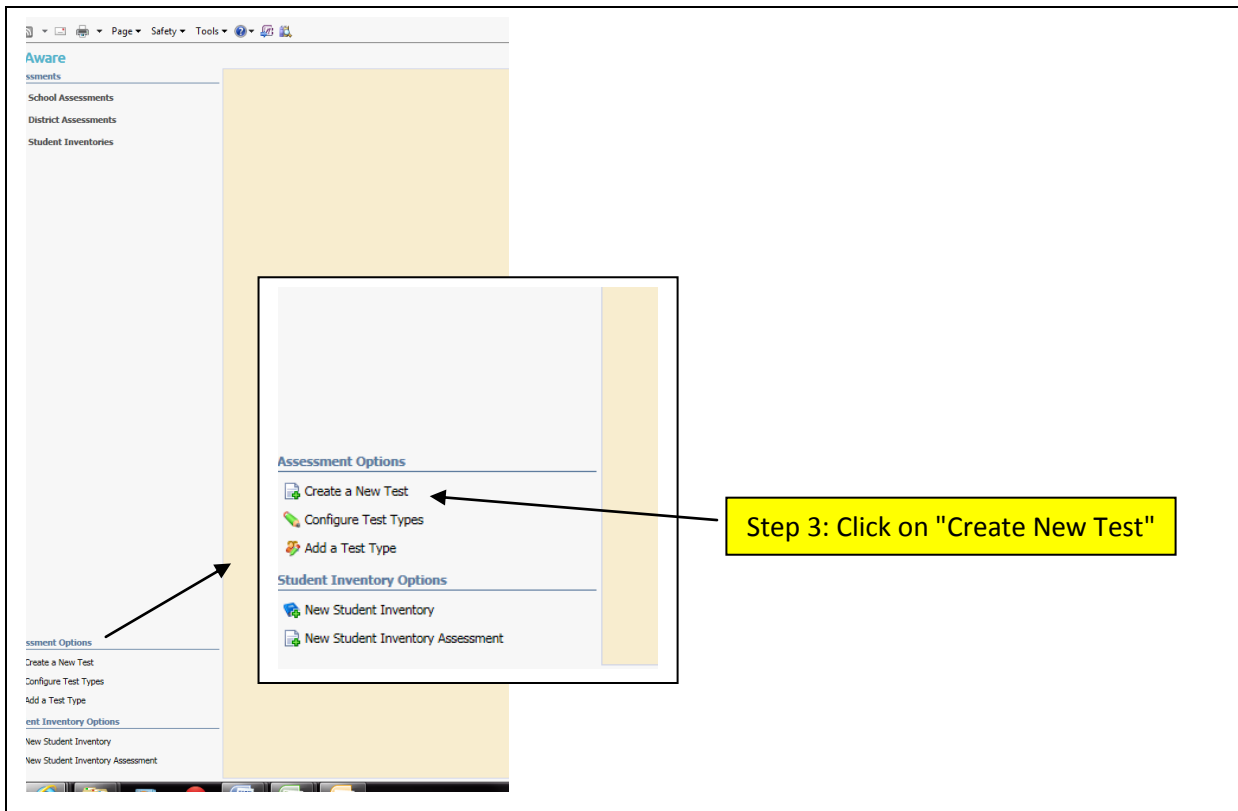

Step 3: Click on "Create New Test"

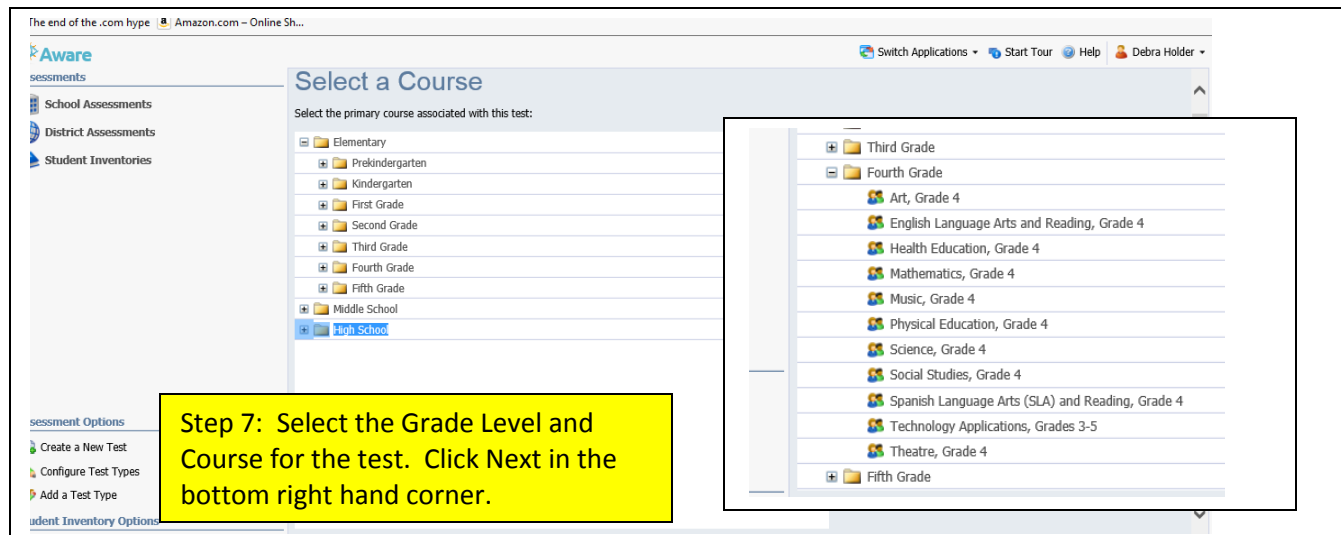
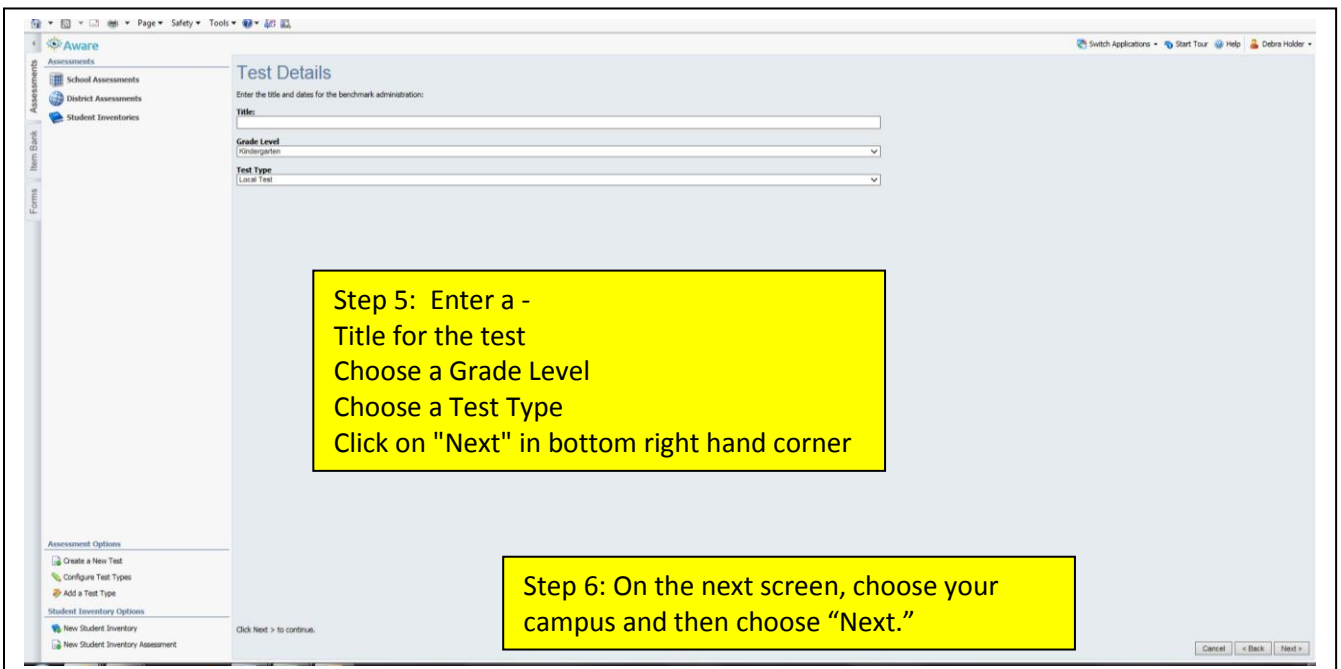
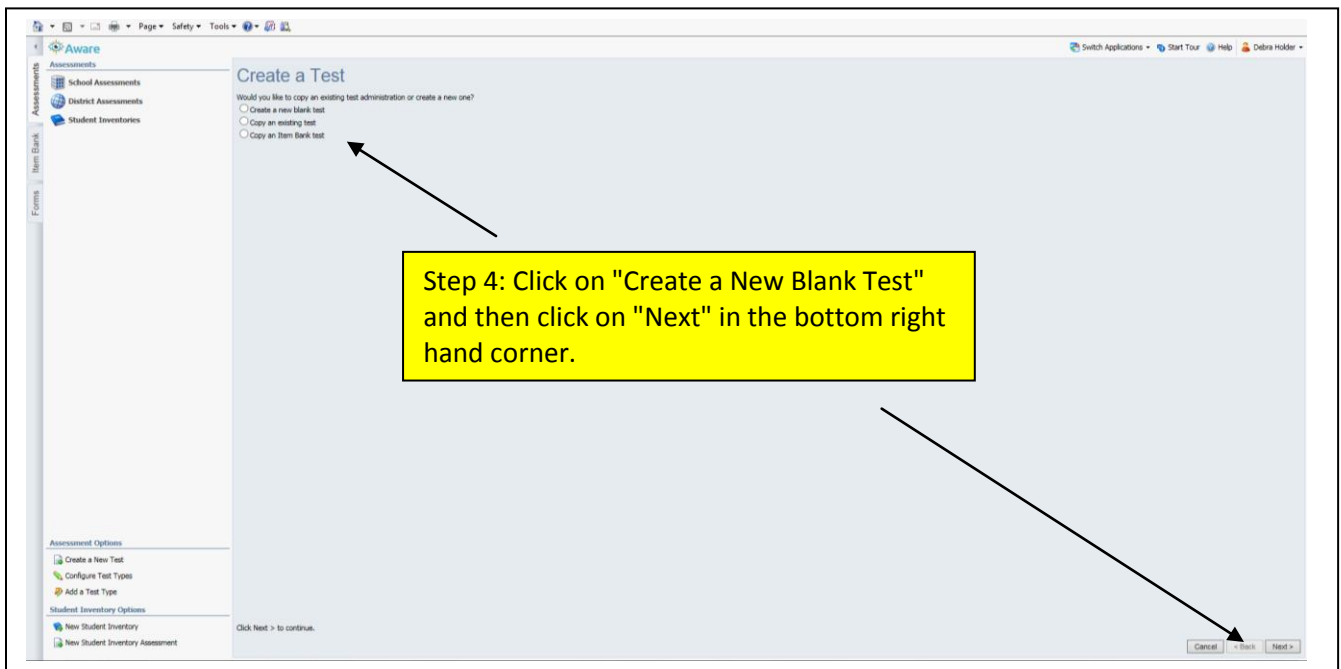

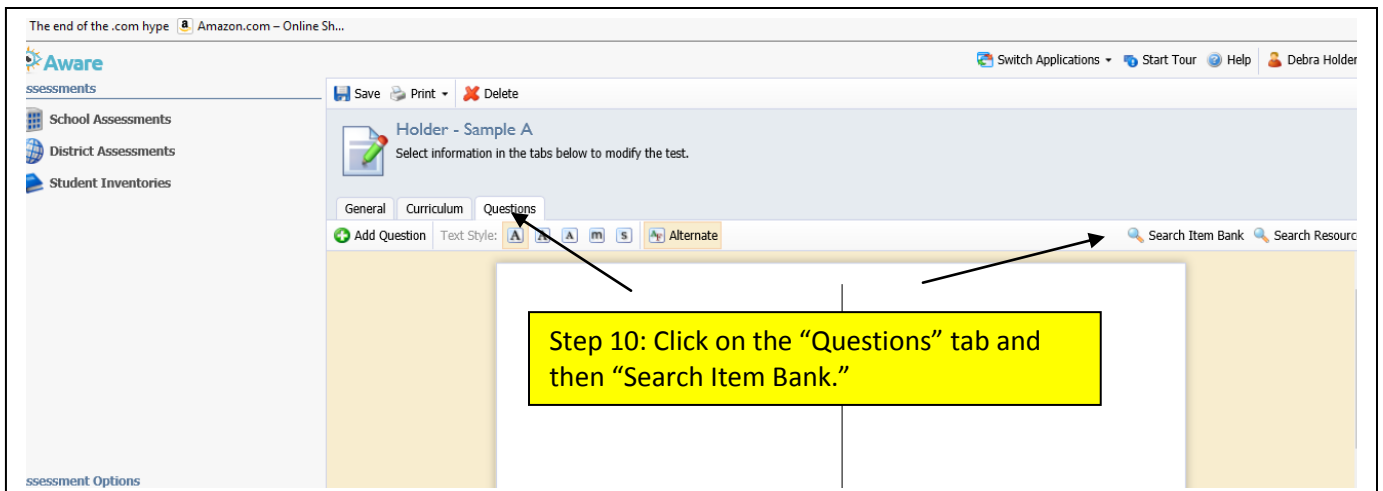
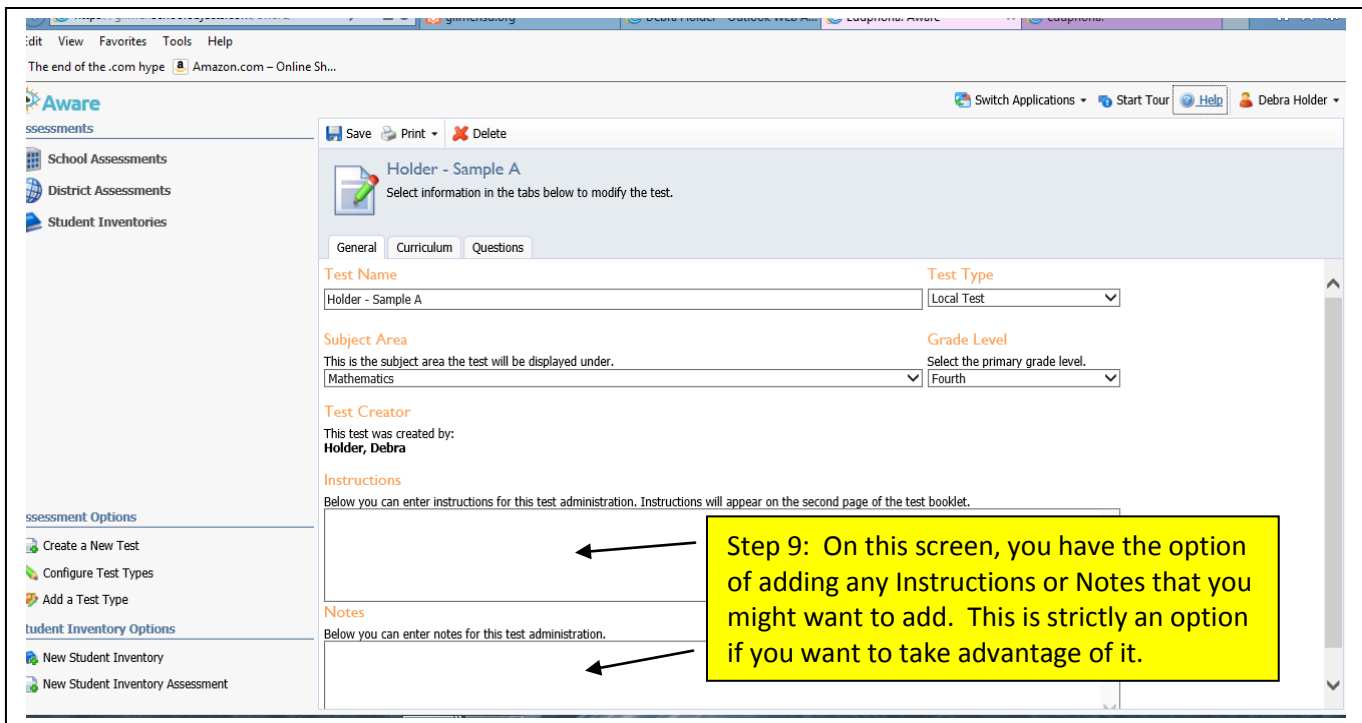
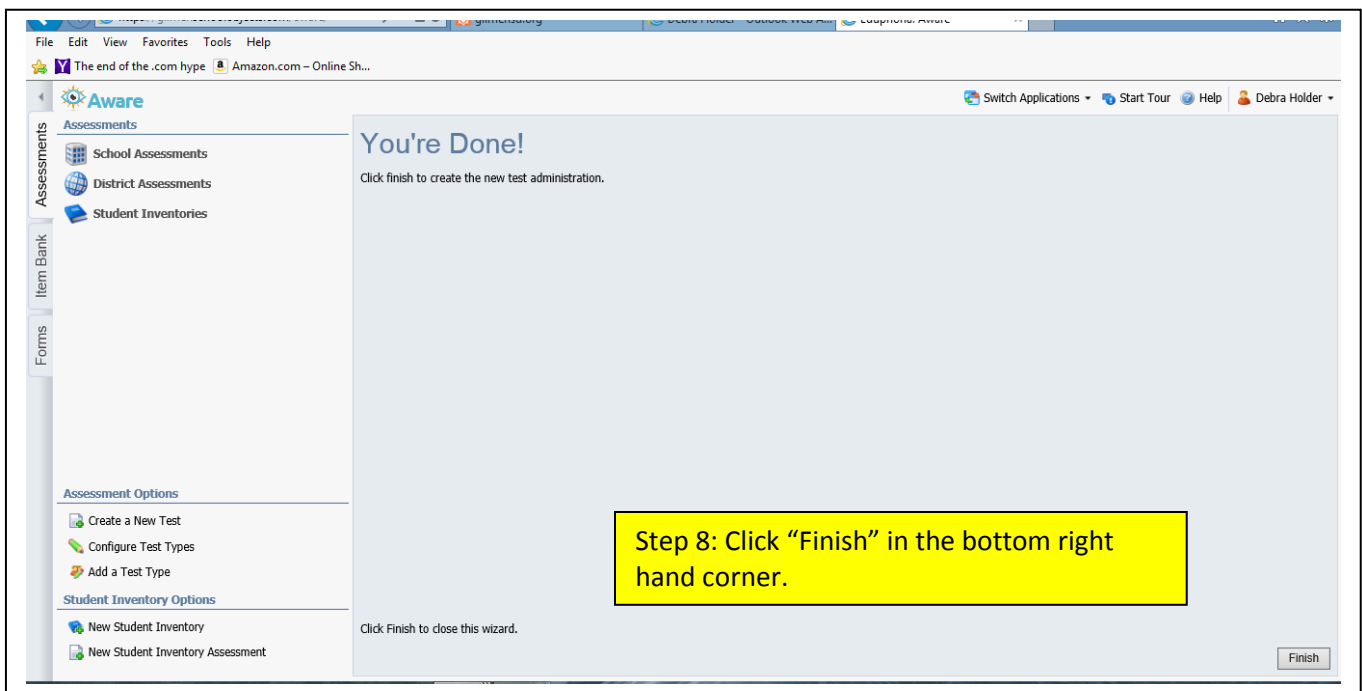

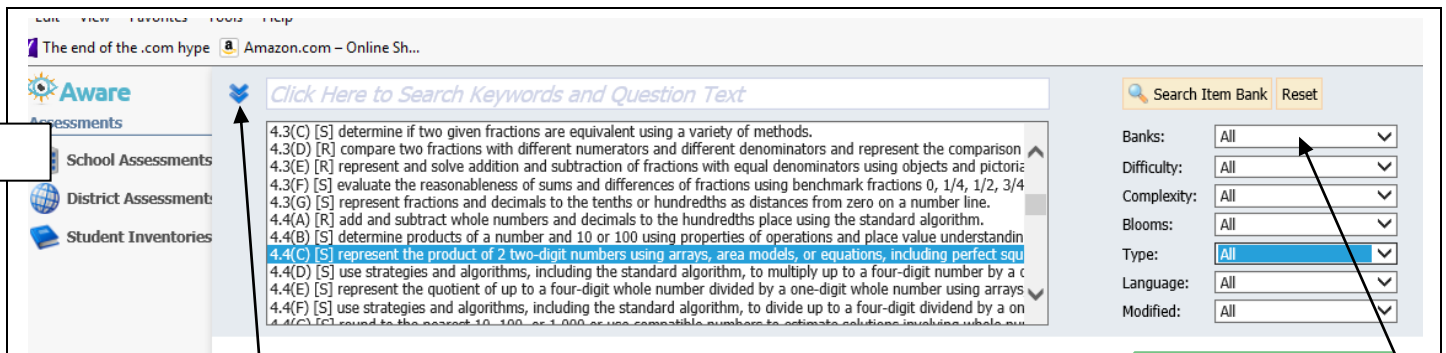

**Step 11:**

- Click on the blue arrow on the left
- Highlight the TEK you are searching for (can only highlight one TEK at a time)
- On the right hand side, you can select the following filters that will help narrow your search: Difficulty Level (easy, medium, hard); Complexity Level (low, medium, high); Blooms; Type (selected response, numerical response, constructed response); Language (English, Spanish); Modified (yes or no – choosing yes will give you questions with only 3 answer choices)
- Click “Search” when you have chosen all of your filters. (Choose as many or as few filters as you like)

We have a new set of items to choose from! Click on **Banks** to see the option of using STAAR Test Maker. Or leave the default of **ALL** to see all items available for that standard.

Should you get a Security Warning that asks –

Do you want to view only the webpage content that was delivered securely?  
(This will be in a pop-up window) –

Select **NO**. This should pull in all images with the questions.

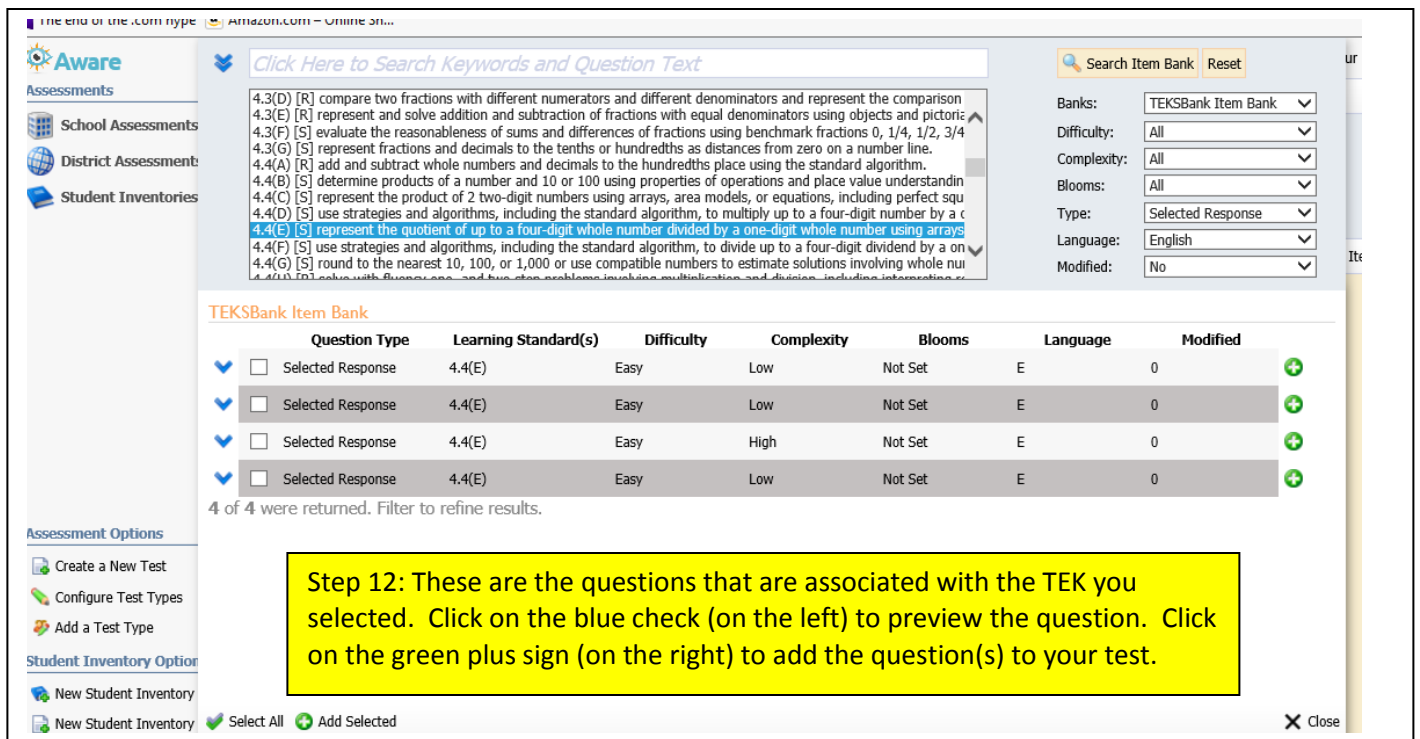

**Step 12:** These are the questions that are associated with the TEK you selected. Click on the blue check (on the left) to preview the question. Click on the green plus sign (on the right) to add the question(s) to your test.

1 Mararet is displaying all of her 28 miniature toys in rows on a shelf. She wanted to put the same number of toys in each row. To do this, she would have to divide 28 evenly. Which is **NOT** a factor that will divide 28 evenly?

- A 4
- B 7
- C 12
- D 14

Answer: C Standard: 4.4(H) [R]

2 Mr. Rye has 15 roses and 21 daisies to put in three vases. He wants to put the same number of roses in each vase and the same number of daisies in each vase. How many flowers will be in each vase?

- F 5
- G 7
- H 12
- J 14

Answer: H Standard: 4.4(H) [R]

3 The fifth grade is planning a trip. There will be 126 children and 40 teachers and parents on the trip. If each bus holds 30 people, how would the remainder of 16 people best be interpreted?

- A a quantity left over
- B a quantity discarded or not used
- C a quantity partitioned into fraction form
- D a quantity forced to the next highest whole number

Answer: D Standard: 4.4(H) [R]

4 The town of Bemington has an Independence Day parade. The local DAR group gives small pins to each of the 927 people who attend the parade. If the pins came in 9 boxes and no pins were left over, how many pins were in each box?

- F 13 pins
- G 103 pins
- H 309 pins
- J 8343 pins

Answer: G Standard: 4.4(H) [R]

Step 13: (OPTIONAL) The blue arrows allow you to move the question up or down in your test. For instance, if you wanted question 3 to be question 1, you would click the up arrow until it moved to question 1.

The green pencil allows you to edit the question. More about that below.

The correct answer and the SE will not show up on the test.

Question Options Standards Resources TEKSBank

8 Kurt bought some new baseball cards for his collection. He bought eight cards at one store and then bought seven cards at each of five other stores. How many new baseball cards did Kurt buy in all?

Enter List Items Below

⬆	<input type="radio"/>	75 cards	✖
		Rationale:	
⬆	<input checked="" type="radio"/>	43 cards	✖
		Rationale:	
⬆	<input type="radio"/>	35 cards	✖
		Rationale:	
⬆	<input type="radio"/>	20 cards	✖
		Rationale:	
			+

Remove Question Cancel Finished

Step 14: (OPTIONAL EDITING) As mentioned above, when you click on the green pencil you may edit the question and/or the answer choices.

You may also type in other answer choices and then click on the green plus sign.

You may delete an answer choice by clicking on the red X.

When you are finished editing, click on the green finished checkmark.

After you have chosen a question for the test, you may delete it from the test by clicking on the red X.

Holder - Sample A  
Select information in the tabs below to modify the test.

General Curriculum Questions

+ Add Question Text Style: A A m S Alternate

**Step 15: (OPTIONAL) ADDING YOUR OWN QUESTIONS - Click on the green plus sign and this screen will appear.**

- Mararet is displaying all of her 28 miniature toys in rows on a shelf. She wanted to put the same number of toys in each row. To do this, she would have to divide 28 evenly. Which is **NOT** a factor that will divide 28 evenly?
  - A 4
  - B 7
  - C 12
  - D 14

*Answer: C Standard: 4.4(H) [R]*
- Mr. Rye has 15 roses and 21 daisies to put in three vases. He wants to put the same number of roses in each vase and the same number of
- The fifth grade is planning a field trip. There will be 126 children and 40 teachers and parents on the trip. If each bus holds 30 people, how many buses would the remainder of 16 people best be interpreted?
  - A a quantity left over
  - B a quantity discarded or not used
  - C a quantity partitioned into fraction form
  - D a quantity forced to the next highest whole number

*Answer: D Standard: 4.4(H)*
- The town of Bemington has an Independence Day parade. The parade group gives small pins to each

What type of question would you like to create?

- Selected Response
- Numerical Response
- Constructed Response
- Resource

**You will see this question appear. (You may have to scroll down before you see this.) Open the window and choose the type of question you want to create.**

Question Options Standards Resources

6 Enter Question Text

Enter List Items Below

- Response 1  
Rationale:
- Response 2  
Rationale:
- Response 3  
Rationale:
- Response 4  
Rationale:

Remove Question Cancel Finished

**Once you choose a question type, another window will open. This is what you will see if you choose Selected Response. You would type in your question and answer choices. When done, click Finished at the bottom right corner.**

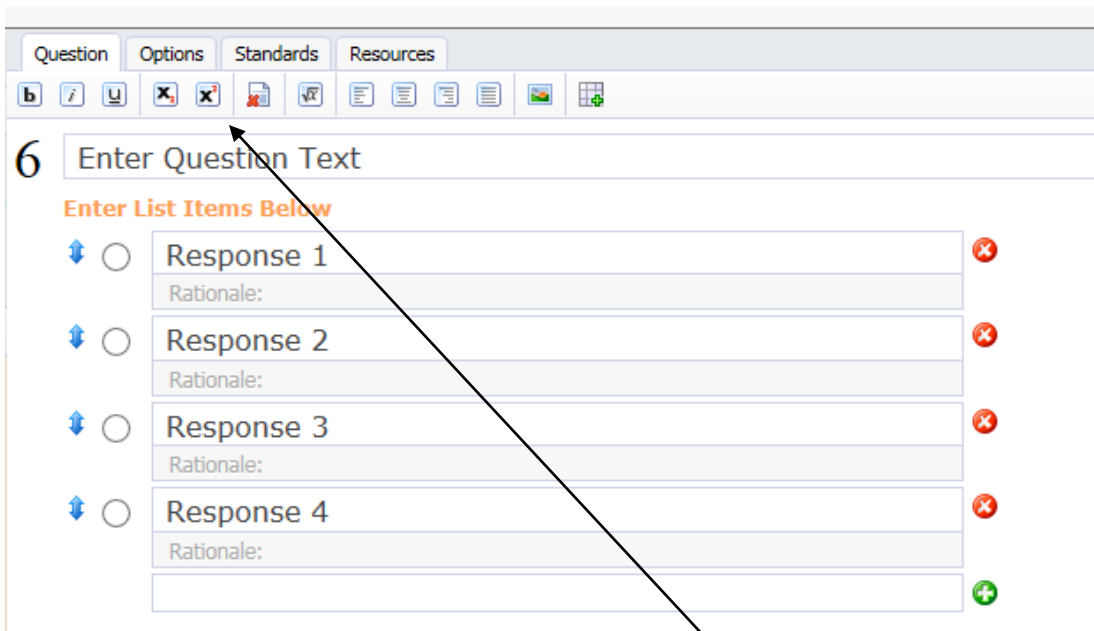

**Buttons across the top from the left -**

1st - Bold print	8th - Align Left
2nd - Italics print	9th - Align Center
3rd - Underline	10th - Align Right
4th - Subscript	11th - Full Justify
5th - Superscript	12th - Insert an Image
6th - Clear Formatting	13th - Insert a Table
7th - Insert Math Equation	

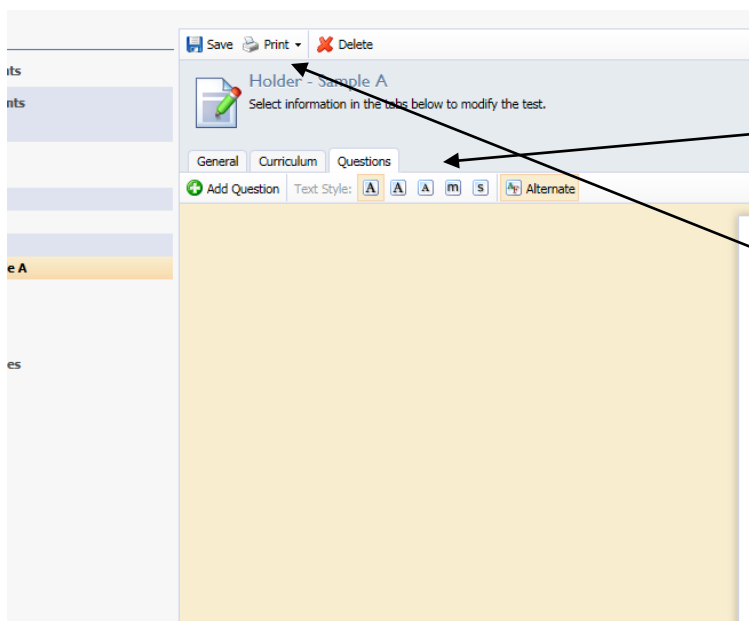

**Step 16:** You can change the size of the print by clicking on the squares with an "A" on them. The square with the M makes the font larger and the question goes across the entire page.

When you are ready to print, click on Print and click on Print Test Booklet. Then go back and print the Test Key. (Be sure to look at your PDF before you print it.)

which is **NOT** a factor that will divide 28 evenly?  
**A** 4  
**B** 7  
**C** 12  
**D** 14  
*Answer: C Standard: 4.4(H) [R]*

2 Mr. Rye has 15 roses and 21 daisies to put in three vases. He wants to put the same number of roses in

best be in  
**A** a quar  
**B** a quar  
**C** a quar  
 fractio  
**D** a quar  
 highes  
*Answer*

4 The town  
 Independ

# FOR LANGUAGE ARTS TEACHERS ONLY:

There are a few ways you can search for ELA questions.

## TO SEARCH BY GENRE:

Click on Search Resources

Click on the blue arrow and then choose the genre from the choices here

Choose any of the other filters you want to select and then click Search

You do not have to select a TEK

**TEKSBank Item Bank**

Paul Revere's Ride (poem)

Question Type	Learning Standard (s)	Obj/RC	Difficulty	Complexity	Blooms	Language	Modified
Selected Response	4.7(A)	R1	Medium	Medium	Analyzing	E	0
Selected Response	4.7(A)	R1	Easy	Low	Understanding	E	0
Constructed Response	4.3(A)	R2	Medium	Medium	Applying	E	0
Selected Response	4.4(A)	R2	Easy	Low	Understanding	E	0
Selected Response	4.4(A)	()	Easy	Low	Remembering	E	0
Selected Response	4.7	()	Medium	Medium	Understanding	E	0
Selected Response	4.3(A)	()	Easy	Low	Understanding	E	0

Two Dogs

Question Type	Learning Standard (s)	Obj/RC	Difficulty	Complexity	Blooms	Language	Modified
---------------	-----------------------	--------	------------	------------	--------	----------	----------

Filters: Banks: TEKSBank It, Genre: Literary - Poetry, Difficulty: All, Lexile: All, Word Count: All, Language: English, Modified: All

**Search for Literary - Poetry in 4th gr.**  
 The search found 8 poems but you only see two of them in the picture. The 1st poem, Paul Revere's Ride, has 7 questions with it. To preview the question, you would click on the blue checkmark. To add the question to the test, you would click on the green plus sign. The 2nd poem is Two Dogs but you cannot see any of the questions in this picture.

## TO SEARCH BY TEKS:

Click on Search Resources

Click on the blue arrow and then choose the TEK you want to search for

Choose any of the other filters you want to select and then click Search

(In this search, you can see that we searched for Fig. 19E)

**TEKSBank Item Bank**

An Amazing Museum

Question Type	Learning Standard (s)	Obj/RC	Difficulty	Complexity	Blooms	Language	Modified
Selected Response	4.F19(E)	R3	Easy	Low	Understanding	E	0

Amazing Giant Animals

Question Type	Learning Standard (s)	Obj/RC	Difficulty	Complexity	Blooms	Language	Modified
Constructed Response	4.F19(E)	R2	Easy	Medium	Understanding	E	0

A Mother Possum

Question Type	Learning Standard (s)	Obj/RC	Difficulty	Complexity	Blooms	Language	Modified
Selected Response	4.F19(E)	R3	Easy	Low	Understanding	E	0

Animals in Native American Art

Question Type	Learning Standard (s)	Obj/RC	Difficulty	Complexity	Blooms	Language	Modified
---------------	-----------------------	--------	------------	------------	--------	----------	----------

Filters: Banks: TEKSBank It, Genre: All, Difficulty: All, Lexile: All, Word Count: All, Language: English, Modified: No

This search produced more than 10 passages to choose from that had Fig. 19E associated with it. You can jot down the names of those passages and then go back and do a search for those particular passage titles to see all questions/all TEKS associated with that specific passage.